

Dormitory Rooms Structure

This research aims to determine rooms structure in the dormitories, types, surface areas and layouts. There are five main layout:

- 1) Eight beds layout for children aged 0-4 years old.
- 2) Six beds layout for children aged 4-6 years old.
- 3) Six beds layout for children aged 6-12 years old.
- 4) Four beds layout for children aged 12-15 years old.
- 5) Two beds layout for children aged 15-18 years old.

The structures are created according to children's age, needs and abilities.

I. First layout types represent room units where every child has their own desk (except 0-6 years old).

Advantage:

- Every child has their own space for learning and creative work.

Disadvantage:

- This layout types demands dormitories with larger surface area (bigger budget).

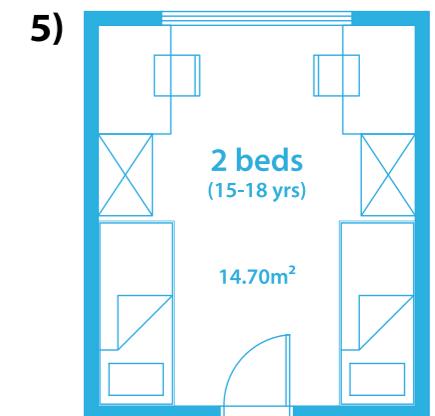
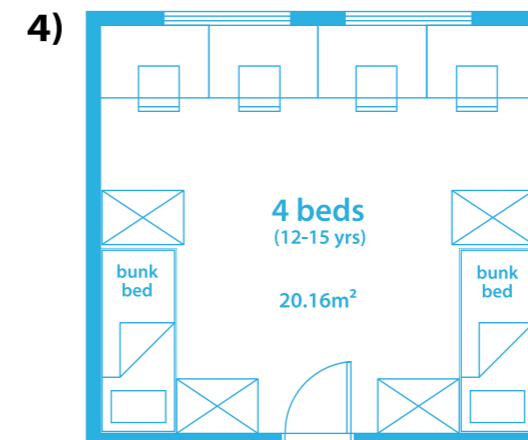
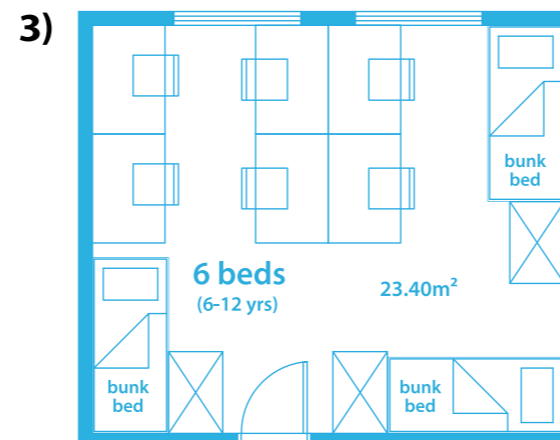
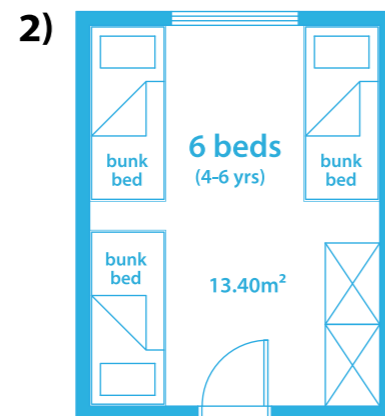
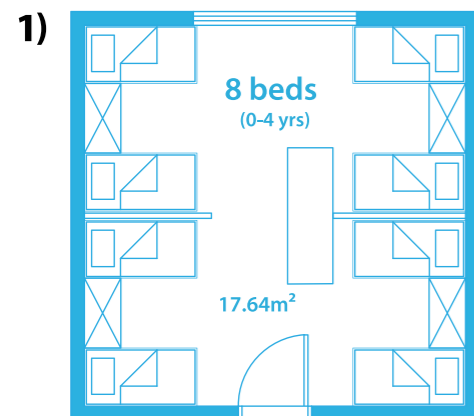

Kindergarten

- 1) 0-4 yrs (150 children) 8 per room
- Room size 17.64m² * 19 rooms = 335.16m²
- 2) 4-6 yrs (50 children) 6 per room
- Room size 17.64m² * 9 rooms = 158.76m²

Primary School

- 3) 6-12 yrs (500 children) 6 per room
- Room size 23.40m² * 84 rooms = 1,965.60m²

Junior Secondary School

- 4) 12-15yrs (200 children) 4 per room
- Room size 20.16m² * 50 rooms = 1,008m²

Senior Secondary School

- 5) 15-18 yrs (100 children) 2 per room
- Room size 14.70m² * 50 rooms = 735m²

TOTAL 4,154m² Surface area without hallways, staff, technical room etc.